

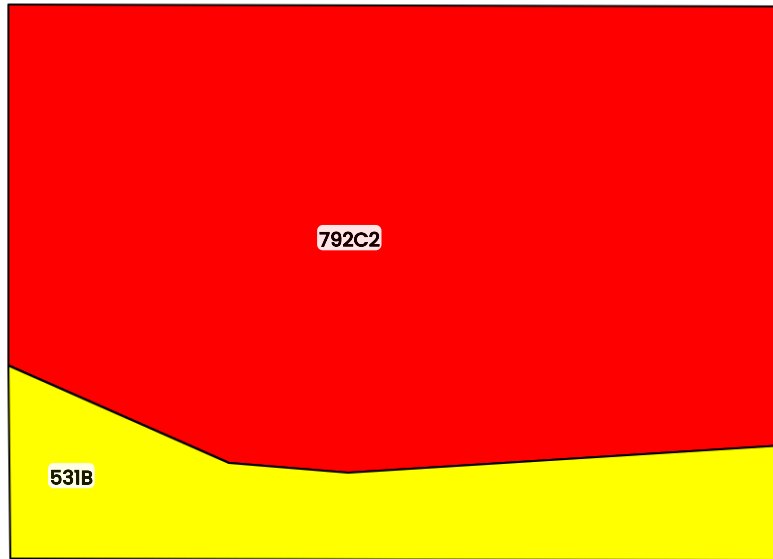

26369 HIGHWAY T30

TOTAL SOILS



FarmWorth®

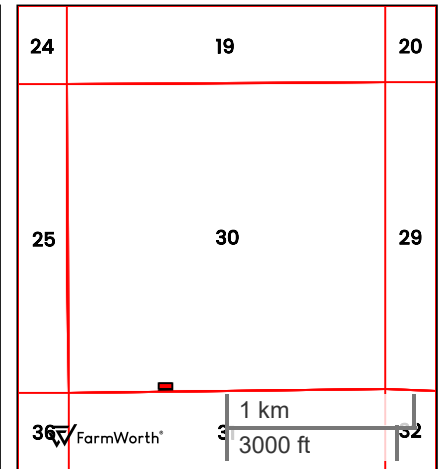

County: **Appanoose County, IA**

Location: **30-68N-17W**

Township: **Caldwell**

Acres: **0.71**

Date: **01/06/2026**



Field borders obtained from Farm Service Agency
as of 2008

FarmWorth, LLC makes no representations or warranties, express or implied, as to the accuracy of any information, data, numerical values, boundaries, or any other information generated through the use of FarmWorth.com. User is solely responsible for independently investigating and determining all information provided through FarmWorth.com prior to use and waives any and all claims against FarmWorth, LLC for any inaccuracies or inconsistencies in the information and/or data.

Code	Description	Acres	% of field	IA CSR2	Overall NCCPI	Soil Class (Irr)	Soil Class (Non-Irr)	Drainage Class
792C2	Armstrong loam, 5 to 9 percent slopes, moderately eroded	0.57	80.28 %	31	66	-	3	Somewhat poorly drained
531B	Kniffin silt loam, 2 to 5 percent slopes	0.14	19.72 %	55	68	-	3	Somewhat poorly drained
Average:				35.7	66.4			

IA has updated the CSR values for each county to CSR2.
Soils data provided by USDA and NRCS.